



Installation Sheet – Stack Kit

Instructions:

1. The stacking bracket is used in conjunction with the feet accessory to stack multiple CoolCube 10 modules.
2. The stacking bracket is attached to the right side of the CoolCube (opposite the power cord) with the (2) side screws from the bottom CoolCube module and the (3) side screws from the top CoolCube module. Align the front middle hole on the bracket with the front of the CoolCubes.
3. The top CoolCube module must have the feet accessory attached to the bottom.
4. If you have any questions, please contact your CoolCube reseller or Contact MaxPower at 800-576-3966 or sales@coolcube10.com

Inventory:

(1) Stacking Bracket

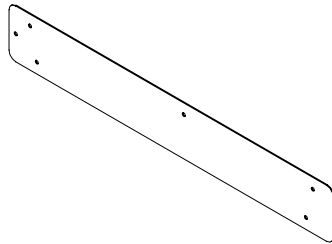

(4) Compression Mount Feet

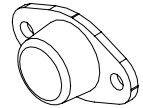

(8) Screws & Washers

